

## INSTALLATION INSTRUCTIONS

### Extension for 3/4" Thermostatic Valve Part #: J-TH34-EXT

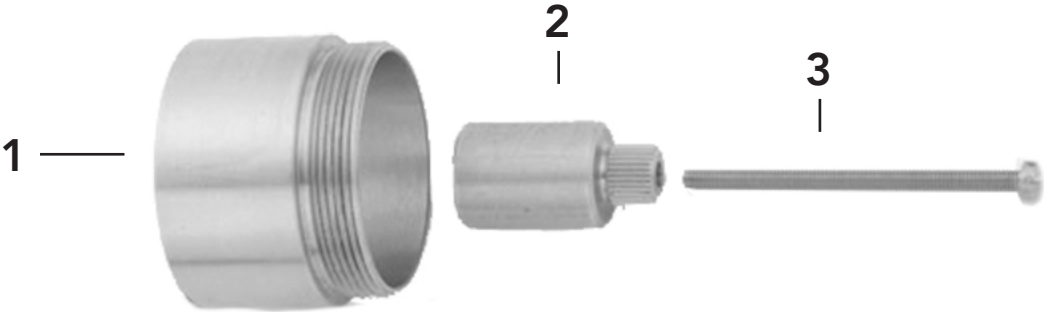

# PARTS



#	DESCRIPTION
1	THERM VALVE COLLAR EXTENSION
2	THERM SPLINE EXTENSION
3	REPLACEMENT MACHINE SCREW

# PREPARATION

**HAVE INSTALLATION INSTRUCTIONS FOR ROUGH AND TRIM ON HAND FOR THIS BEFORE BEGINNING.** MAKE SURE WATER IS TURNED OFF, AND RUN ANOTHER FUNCTION ON THAT LINE TO RELIEVE PRESSURE IN LINE. REMOVE HANDLES AND TRIM PLATE (IF INSTALLED)

# INSTALLATION

## THERMOSTATIC VALVE:

1. Remove temperature dial and pointer. (Put screw back into spline to keep assembled)
2. Remove finished collar from trim.
3. Put unfinished **Collar Extension (1)** on rough, thread finished collar onto extension. (May be necessary to re-align the black dial pointer to the 12 o'clock position)
4. Add **Therm Spline Extension (2)** (stacking) on. Temporarily put screw back through to limit stops in same location.
5. Replace spline adapter from trim.
6. Turn check stops back on, test, then re-install trim.

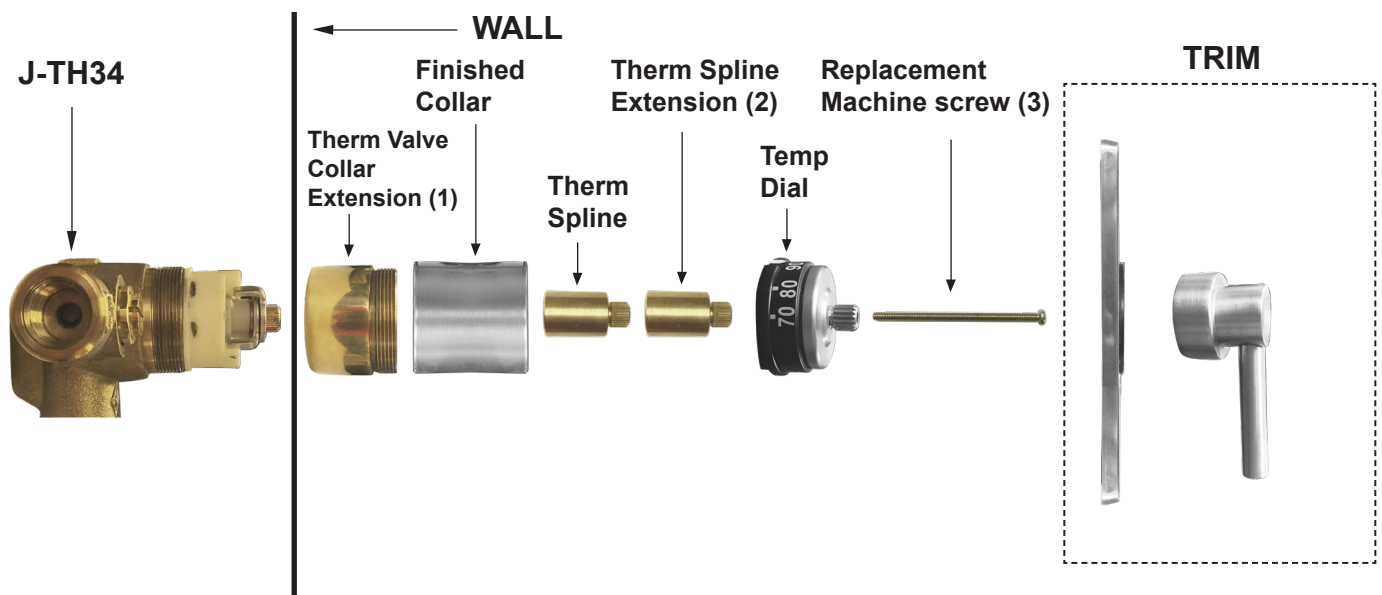

To learn more about JACLO's warranty, please visit **[jaclo.com](http://jaclo.com)**