

# INSTALLATION INSTRUCTIONS

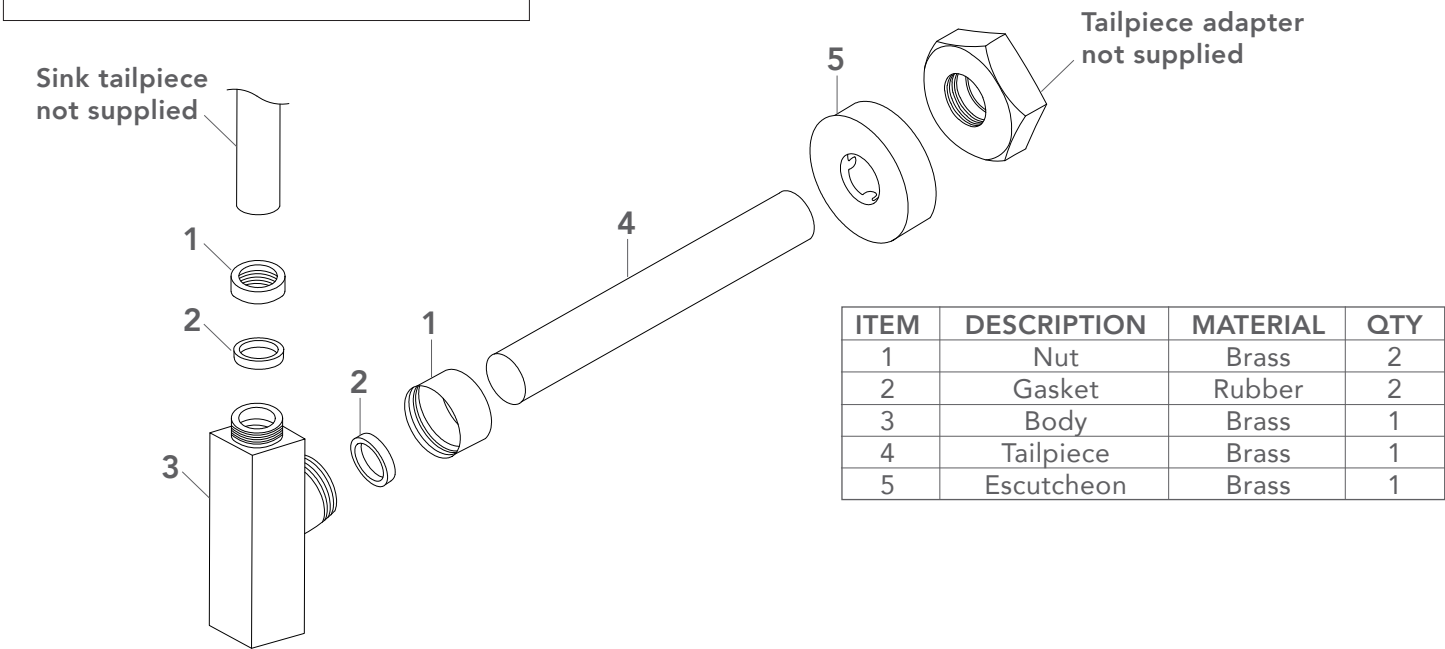

**Decorative Traps**  
Part #'s: 255, 256, 255-KN, 256-KN, 270, 271, 257,  
258, 273, 274, 275, 276

IAPMO Certified File #5959



## INSTALLER WARNING

- Follow all applicable Local Plumbing Codes, Public Health and Safety Codes.
- We recommend this product be installed only by a qualified professional contractor/plumber

## Preparation

- Sink or basin is installed in final position
- Sink drain is installed in sink basin
- Wall "stub" connection is complete with tail piece adapter/connection close to wall so escutcheon covers it

## Trap Installation

- Position body under sink, measure wall tail piece length, cut wall tail piece
- Slide escutcheon on to wall tail piece
- Push tail piece in to wall adapter
- Slide nut over wall tail piece
- Lubricate gasket with silicone grease or liquid soap. Slide gasket over wall tail piece
- Slide lock nut over sink tail piece
- Lubricate gasket with silicone grease or liquid soap. Slide gasket over sink tail piece
- Insert trap body into wall tail piece and slide up on to sink tail piece. Position body so a slight decline in wall tail piece is obtained (approximately 5 degrees) tighten sink tail piece lock nut.
- Tighten wall tail piece lock nut
- Tighten wall adapter lock nut
- Slide escutcheon over wall adapter

To learn more about JACLO's warranty, please visit **[jaclo.com](http://jaclo.com)**