

# INSTALLATION INSTRUCTIONS

## Exposed Shower Column

Part #: EXP-HNSND, EXP-HSND, EXP-HNSD, EXP-HSD  
EXP-90NSND, EXP-90SND, EXP-90NSD, EXP-90SD

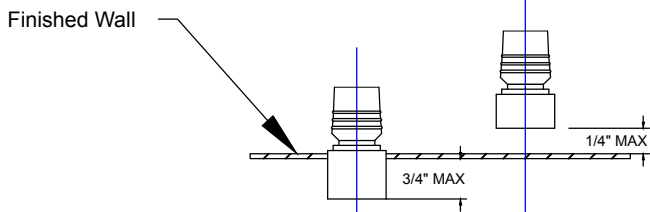

Fig 1

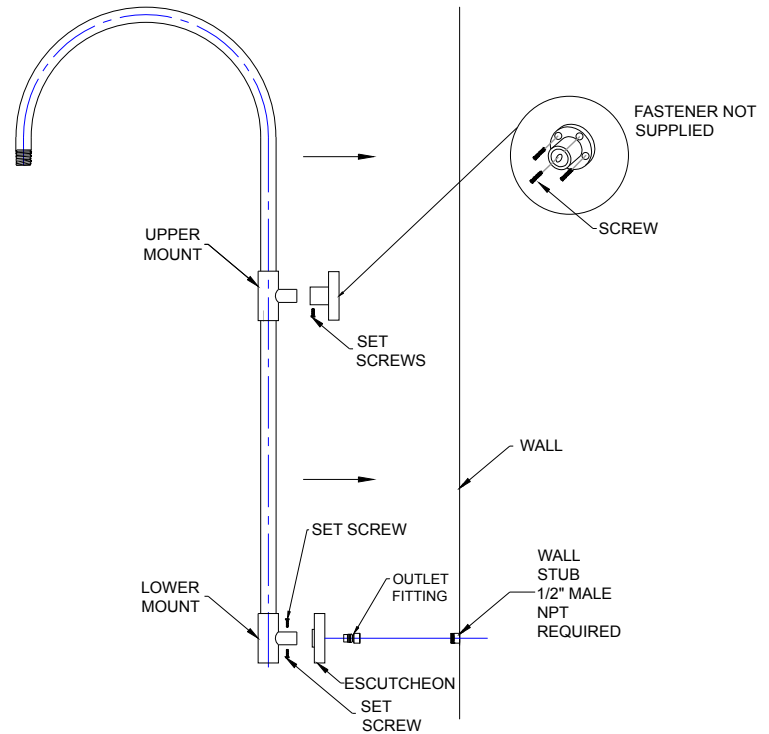
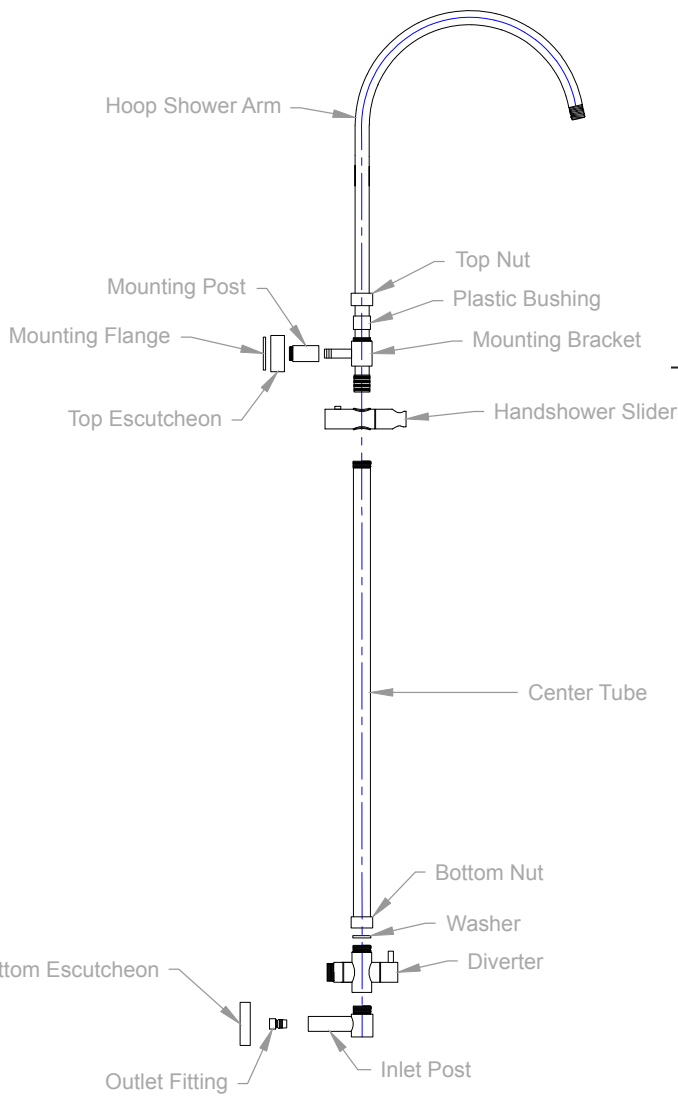

Fig 2

## INSTALLATION

1. Determine position of lower mount. Stub water outlet per Fig 1. using 1/2" NPT fittings
2. Install outlet fitting.
3. Determine location of upper mount and install to wall using appropriate fastener. (Fig 2)
4. Install shower unit (Fig 2)
  - a. Slide escutcheon onto water lower mount
  - b. Lubricate water outlet o-ring with soap or silicone grease and install shower unit into top and bottom mounts.
  - c. Tighten lower mount set screws
  - d. Slide lower escutcheon flush to wall
  - e. Set shower unit parallel to wall and tighten upper mount set screw
  - f. Install showerhead
5. Test unit for leaks



Hoop Shower Rail

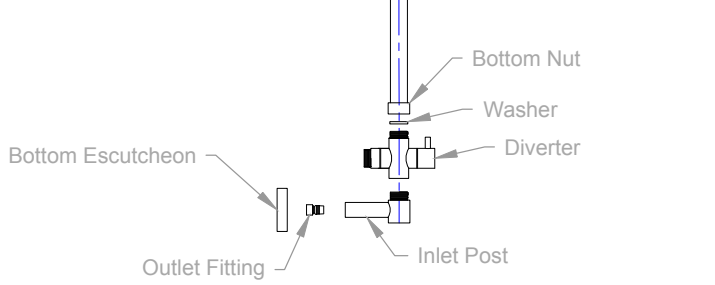

90 Degree Shower Rail

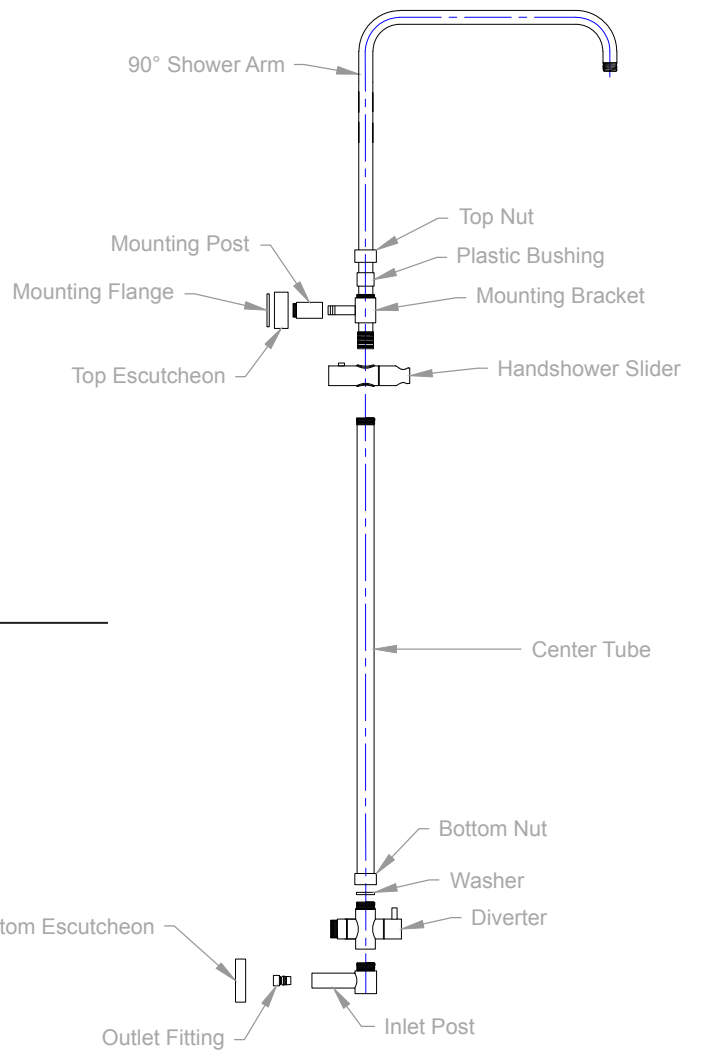

To learn more about JACLO's warranty, please visit [\*\*jaclo.com\*\*](http://jaclo.com)