

# 24" Stainless Steel Commercial 1 1/2" Grab Bar (with Concealed Screws)

Model #: 11224C-SS



FEATURES:

- Stainless Steel Commercial Grab Bar
- Concealed Screws
- 1 1/2" Diameter
- ADA Compliant when properly installed
- Individually bagged with 6 stainless steel screws
- Standard & custom finishes are available for large projects. Contact [hospitality@jaclo.com](mailto:hospitality@jaclo.com) for pricing & availability

AVAILABLE FINISHES:

N/A

SPECIFICATION DRAWING:

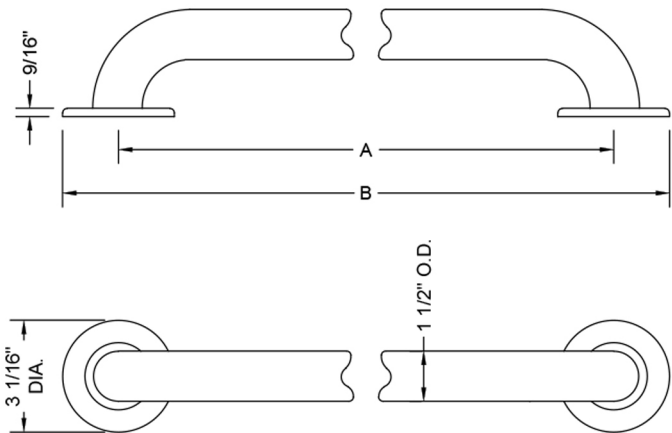

GRAB BARS - DELUXE BRASS			
PART. #	DESCRIPTION	A	B
11218C-SS	1 1/2" O.D. x 18"	18"	21 1/6"
11224C-SS	1 1/2" O.D. x 24"	24"	27 1/6"
11230C-SS	1 1/2" O.D. x 30"	30"	33 1/6"
11236C-SS	1 1/2" O.D. x 36"	36"	39 1/6"
11242C-SS	1 1/2" O.D. x 42"	42"	45 1/6"
11248C-SS	1 1/2" O.D. x 48"	48"	51 1/6"